

National Infrastructure
Planning
Temple Quay House
2 The Square
Bristol
BS1 6PN

17th December 2020

Dear Sirs,

**Development Consent Order for M25 Junction 28 Improvements.
On behalf of our clients Mr and Mrs Jones, Grove Farm, Brook Street, Brentwood, CM14 5NG**

We are writing regarding the procedural deadline B for our suggested locations/sites for the panel to include as part of their unaccompanied site inspections for Grove Farm.

I attach a plan siting our requested locations for inspections. The accompanying notes for each point are as follows:

Point A – The existing access into Grove Farm.

It is noted that the new A12 east bound slip road would be located approximately 20m closer to the residential dwelling and at a significantly greater elevation making it level to the bedroom windows. At present it is appreciated there is no detailed noise and vibration mitigation measured guidance available therefore we are unable to understand the impact on the clients living conditions. We ask that you stand in the area to fully appreciate the impact on the clients lives.

Point B – The proposed access into the maintenance route

We are requesting that the Examining Authority walks the route between these two points and considers that it is feasible and preferable for these to be combined in to one access near to the substation serving both the site and the maintenance requirements.

Point C – The existing exit

It proposed that the works will ingress further on to Grove Farm to accommodate the existing access that the property uses to exit the site. This exit will be 20meters shorter than previous, reducing the space for vehicles to wait when existing the site. It is believed that it would be feasible and preferable to move the exit westwards down the slip road away from the house.

Point D – The proposed balancing pond

This is located at the end of the proposed maintenance track. It is requested that this site is inspected to appreciate the need for it to be located at the furthest point north of the property to keep it away from the other activities on site.

Chartered Surveyors, Valuers, Auctioneers & Estate Agents



Diamond Way • Stone Business Park • Stone • Staffordshire • ST15 0SD

Tel: 01782 713444 / 01785 850866

info@hinsonparry.co.uk • www.hinsonparry.co.uk

William Parry Ltd. • Roger Bedson Ltd.

Consultant: John C Hinson Ltd.

VAT Registration Number: 537050659 • Regulated by the RICS



These areas can be accessed by prior notification to us to allow for access to be had on site. We would request that examiners park near the original entrance and then walk the grounds from this point. We would be happy to discuss closer to the time.

Please note we reserve the right to amend, alter and add to these proposed site inspection points if we feel any future documentation released in the future warrants further inspections.

Yours faithfully,

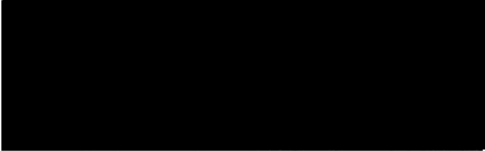

Rebecca Evans BSc (hons) MRICS FAAV
Associate
For and on behalf of Hinson Parry

DO NOT SCALE

Millimetres
0 10 100



FOR CONTINUATION REFER TO SHEET 3

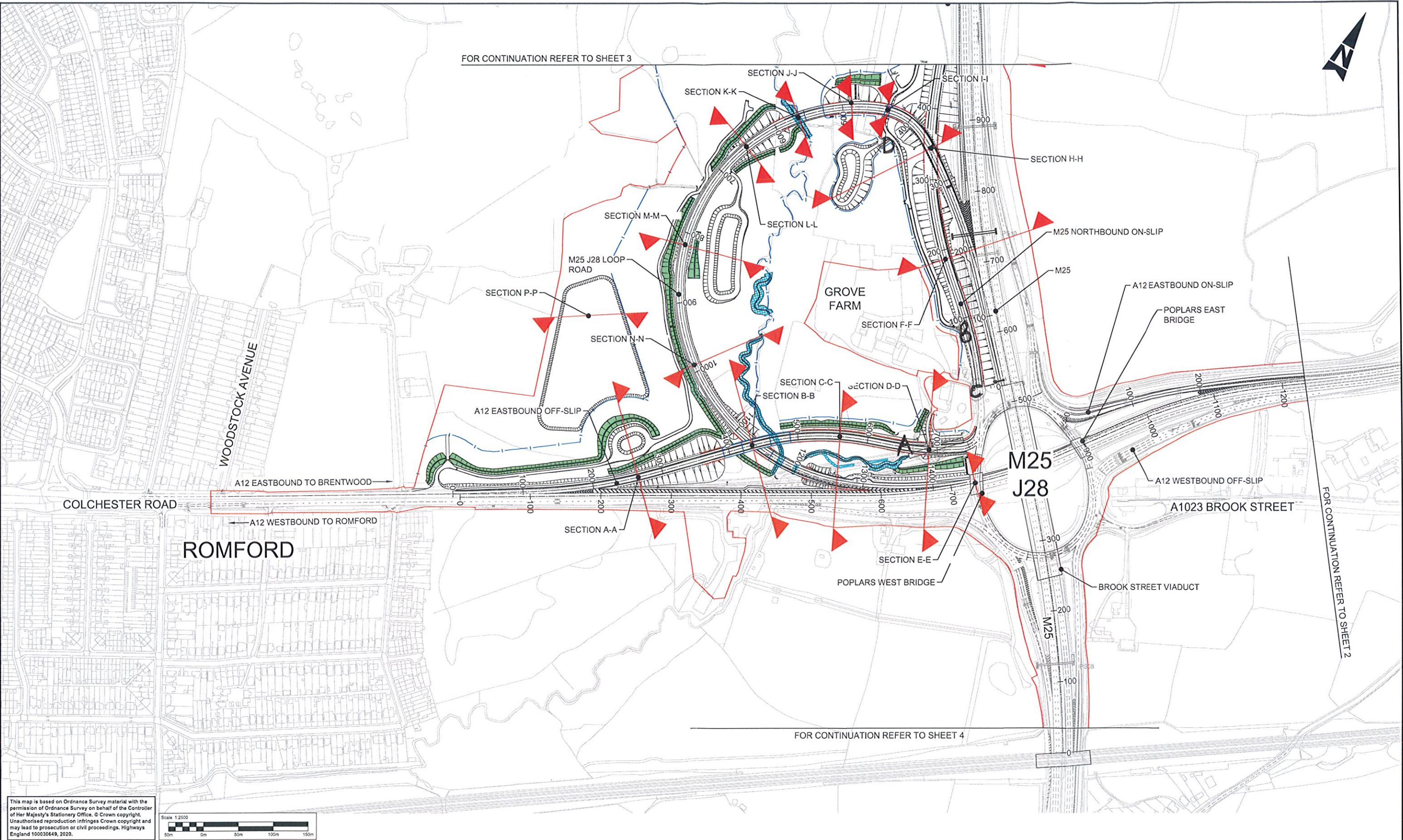

FOR CONTINUATION REFER TO SHEET 2

FOR CONTINUATION REFER TO SHEET 4

This map is based on Ordnance Survey material with the permission of Ordnance Survey on behalf of the Controller of Her Majesty's Stationery Office. © Crown copyright. Unauthorised reproduction infringes Crown copyright and may lead to prosecution or civil proceedings. Highways England 100030649, 2020.



- NOTES:**
- All dimensions are in metres unless otherwise stated.
 - Do not scale from this drawing.
 - For cross sections details refer to the following sheets.
- | | |
|--------------------|--------------------|
| A-A - Sheet 1 of 6 | J-J - Sheet 4 of 4 |
| B-B - Sheet 1 of 6 | K-K - Sheet 4 of 4 |
| C-C - Sheet 2 of 6 | L-L - Sheet 5 of 6 |
| D-D - Sheet 2 of 6 | M-M - Sheet 5 of 6 |
| E-E - Sheet 3 of 6 | N-N - Sheet 5 of 6 |
| F-F - Sheet 3 of 6 | O-O - Sheet 6 of 6 |
| G-G - Sheet 3 of 6 | P-P - Sheet 6 of 6 |
| H-H - Sheet 4 of 6 | |
| I-I - Sheet 4 of 6 | |

- KEY :**
- Development Consent Order (DCO) boundary
 - Proposed boundary
 - Existing boundary
 - Proposed bridge
 - Proposed retaining wall
 - Typical cross-section
 - Proposed pre-earthwork ditch
 - Realigned watercourse

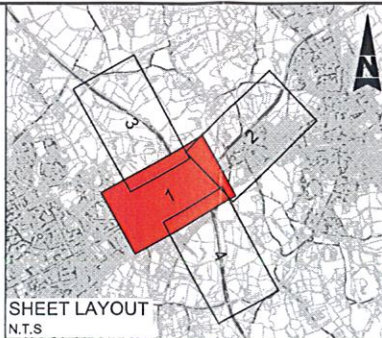

Description	Status	Revision	Drawn	Checked	Reviewed	Authorised	Issue Date

Drawing Suitability		Status		Project Title	
DCO APPLICATION		A4		M25 junction 28 improvement scheme	
				Amlin House Atkins 4th Floor 90-96 Victoria Road Chelmsford Essex CM1 1QU Tel: +44 (0)1245 245245 Fax: +44 (0)1245 345010 www.atkinsglobal.com	
Member of the SNC-Lavalin Group Copyright © SNC Lavalin (2020)				ENGINEERING SECTIONS REGULATIONS 5(2)(O) AND 6(2) SECTION LOCATION PLAN SHEET 1 OF 4	
Working on behalf of 				Drawing Number TR010029/APP/2.8	
Client				Rev: 0	
HE PIN: HE551519		Scale: 1:2500		Original Size: A1	